

INDUSTRIAL PLANTER W/ DRIP TRAY - OG-IP-65-GGY

APPROX WEIGHT: 30.28 lbs.
 DOES NOT INCLUDE WEIGHT OF POWER OR PACKAGING!!!

*** ANY ADDITIONS, DELETIONS, OR OMISSIONS MUST BE CORRECTED ON THIS DRAWING AS THIS DRAWING WILL BE CONSIDERED ALL INCLUSIVE ***

ALL GRAPHICS PROVIDED ARE FOR REFERENCE ONLY. IF CERTAIN DIMENSIONS ARE CRITICAL PLEASE VERIFY THOSE DIMENSIONS WITH YOUR SALESPERSON

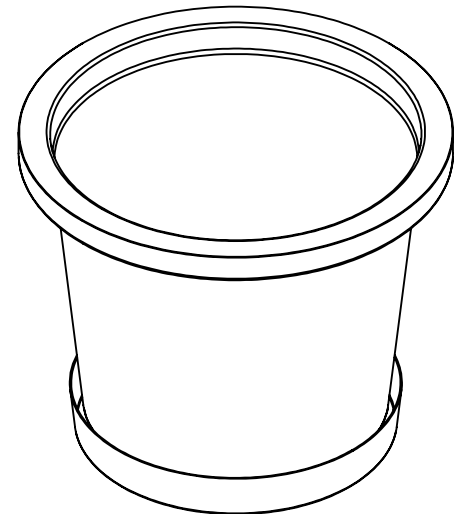
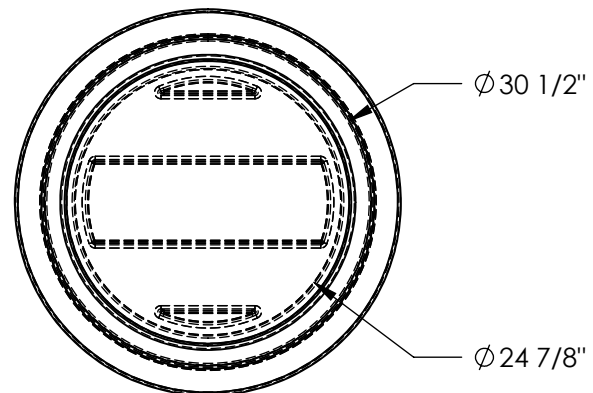
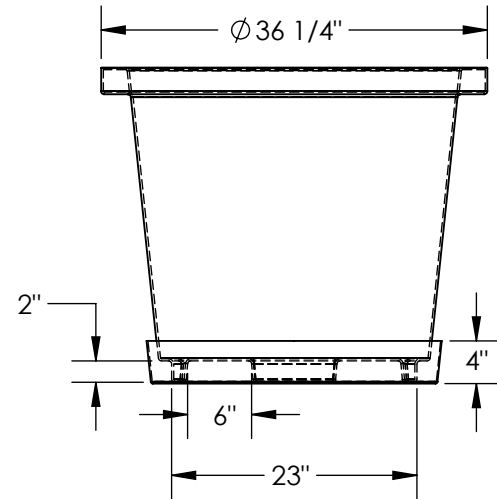
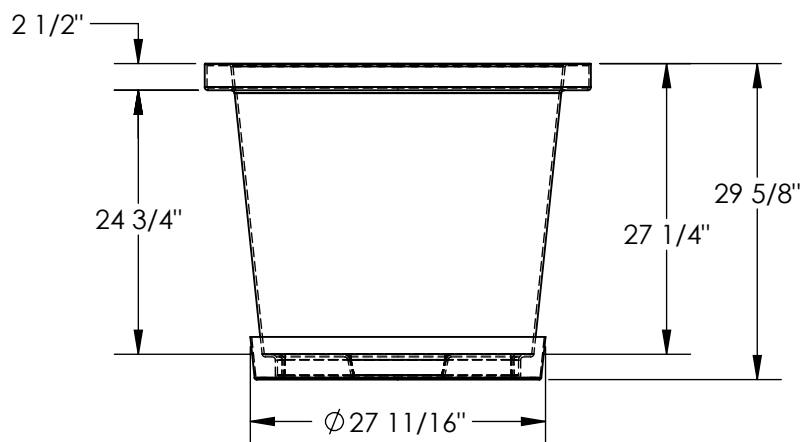

DIMENSION TOLERANCE ± 1/4"

STANDARD FEATURES

- MODEL NUMBER IS: OG-IP-65-GGY
- OVERALL DIAMETER IS: 36 1/4"
- OVERALL HEIGHT IS: 29 5/8"
- FORK SLOTS ARE: 6" WIDE x 2" HIGH
- INCLUDED DRIP TRAY OVERALL DIAMETER IS: 27 11/16"
- INCLUDED DRIP TRAY OVERALL HEIGHT IS: 4"
- MATERIAL IS: HIGH-DENSITY POLYETHYLENE
- COLOR IS: GRANITE GREY
- PLANTER MAX WEIGHT CAPACITY IS: 800 LBS
- PLANTER MAX VOLUME CAPACITY IS: 65 GALLONS
- DRIP TRAY MAX VOLUME CAPACITY IS: 9 GALLONS
- DRIP TRAY VOLUME CAPACITY W/ PLANTER IS: 3 GALLONS

SPECIAL FEATURES

NONE

A P P R O V A L

I, THE UNDERSIGNED, AGREE THAT THE PRODUCT AS REPRESENTED SATISFIES DESIGN AND DIMENSION REQUIREMENTS. I ALSO ACKNOWLEDGE MY DUTY TO CONFIRM PRODUCT AND INSTALLATION COMPLIANCE WITH ALL APPLICABLE FEDERAL, STATE AND LOCAL REGULATIONS AND STANDARDS.

UNITS REQUIRING APPROVAL DRAWINGS OR MODIFIED ARE NON-RETURNABLE

[] As drawn [] As marked

Signed: _____ Date: _____

Printed Name: _____

LEAD TIME WILL START UPON RECEIPT OF SIGNED APPROVAL DRAWING

FOR INTERNAL USE ONLY PROJECT SIGN OFF	
SALES	
ENG.	
FAB.	
POWER	

DISTRIBUTOR'S NAME: VESTIL MANUFACTURING		P.O.# X
DRAWN BY: JGP		W.O.# X
DATE: 10/12/2020	SALES: X	FILE NAME: 31-007-323
REFERENCE: X	SCALE: 1:18	
QUOTED LEAD TIME: X	QUOTE # X	